

# ATTACHMENTS

## 8020 Series Tractors

---

Issue 02/2006    Region II



John Deere Werke Mannheim



**JOHN DEERE**

Genuine Parts and Service

# ATTACHMENTS FOR FIELD INSTALLATION

Unless otherwise indicated, the following attachments can be installed on all 8020-Series tractors. Please note that under „Order From“ it is indicated where the individual field installation kits can be sourced through. The denoted „EPDC“ bundles can be ordered through the normal parts channels. The denoted „CG“ bundles are available through complete goods channels.

## OPERATOR STATION

### FIELD OFFICE



The attachment kit includes Field Office, electrical convenience outlet, wiring harness and installation hardware & instructions.

*Note: Not compatible with Comfort Passenger Seat.*

Order From	Bundle	Description
EPDC	AR116863	Field Office Kit <i>Not compatible with RE192707 Instructional Seat.</i>

### ACCESSORY MOUNTING BRACKET



The attachment kit includes a mounting bracket, installation hardware & instructions.

Order From	Bundle	Description
EPDC	RE162262	Accessory Mounting Bracket

### TRAY & DRINKS HOLDER



The tray has a recessed flat area plus a drinks holder. This attachment kit includes a Tray & Drinks Holder combination and installation hardware.

Order From	Bundle	Description
EPDC	RE162644	Tray & Drinks Holder Kit

*Note: Requires Accessory Bracket*

## INSULATED COOL BOX



The Insulated Cool Box aids operator comfort by keeping food and drinks cool and stored securely. The box can be quickly removed for cleaning or movement between machines. Includes fastening straps and mounting hardware.

Order From	Bundle	Description
EPDC	AL112070	Insulated Cool Box

## REFRIGERATED COOL BOX



The 12-volt Refrigerated Cool Box will keep food and drinks chilled through hot working conditions. The box is capable of maintaining a 30°C difference to ambient temperatures and its 6-litre capacity will take standard 0.75 l bottles.

The kit additionally features a battery security system preventing accidental discharge while the box is still connected to the cabin's 12-volt cigarette lighter outlet without the engine running. The box can be easily removed for cleaning or for movement between machines.

Order From	Bundle	Description
EPDC	MC900001	Refrigerated Cool Box
EPDC	MC900002	Mounting kit

## REAR PULL DOWN SUN SHADE

A pull-down shade for the rear windshield improves operator visibility on sunny days by blocking direct light and reducing glare.

Order From	Bundle	Description
EPDC	RE197944	Rear Pull Down Sun Shade.

## COMFORT PASSENGER SEAT



Comfort Passenger Seat provides a comfortable, and convenient location to sit while instructing new or inexperienced operator.

Order From	Bundle	Description
EPDC	RE192707	Comfort Passenger Seat <i>Not compatible with AR116863 Field Office.</i>

### FOLDING PASSENGER SEAT



The attachment kit includes a Folding Passenger Seat.

Order From	Bundle	Description
EPDC	AL114321	Folding Passenger Seat
EPDC	AR113039	Folding Passenger Seat Mounting Kit <i>SN: 009999 and below</i>
EPDC	AR116858	Folding Passenger Seat Mounting Kit <i>SN: 0100000 and above</i>

*Note: Requires folding passenger seat mounting kit. Serial number required.*

### FOLDING PASSENGER SEAT SUSPENSION



The attachment kit includes Seat Suspension for Folding Passenger Seat.

Order From	Bundle	Description
EPDC	AL114856	Seat Suspension

### FOLDING PASSENGER SEAT SAFETY BELT

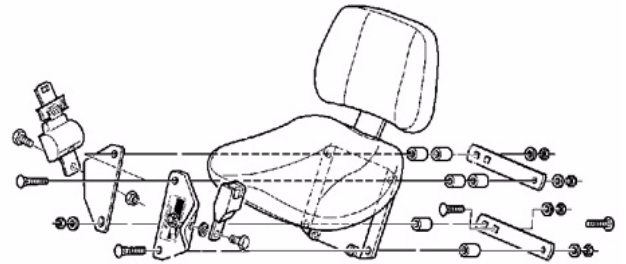

The attachment kit includes Safety Belt and installation hardware and instructions for Folding Passenger Seat.

Order From	Bundle	Description
EPDC	AL117734	Safety Belt Kit

### REPLACEMENT FLOOR MAT

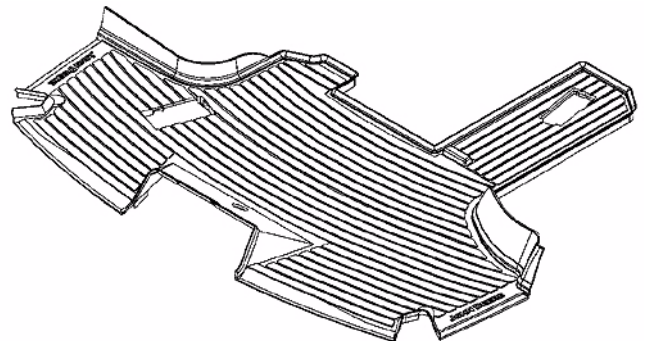

Replacement rubber Floor Mats can be purchased to help restore the cabin's original appearance.

Order From	Bundle	Description
EPDC	R155817	Floor Mat

### RIGHT AND LEFT-HAND STEP KIT



The right-hand step kit includes full-sized steps and handrail as well as an individual step on the left side for improved cab access.



The left hand step provides convenient access to the front window for cleaning and also for GreenStar StarFire Receiver mounting and dismounting:

Tread serrated design is self cleaning and slip resistant.

Order From	Bundle	Description
EPDC	RE197953	Right and Left-Hand Step Kit

### LEFT HAND CONVENIENCE STEP

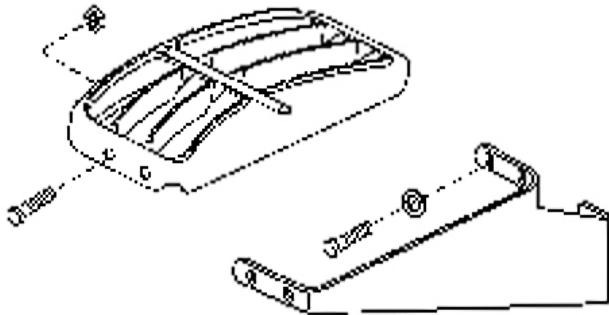

The attachment kit includes the Left Hand Step only, together with installation hardware & instructions.

Order From	Bundle	Description
EPDC	RE162261	Left Hand Convenience Step <i>Requires the following additional parts: 1 x R202182; 2 x 19M7946; 2 x 24M7344; and 2 x 14M7300</i>

### REAR WINDOW WIPER

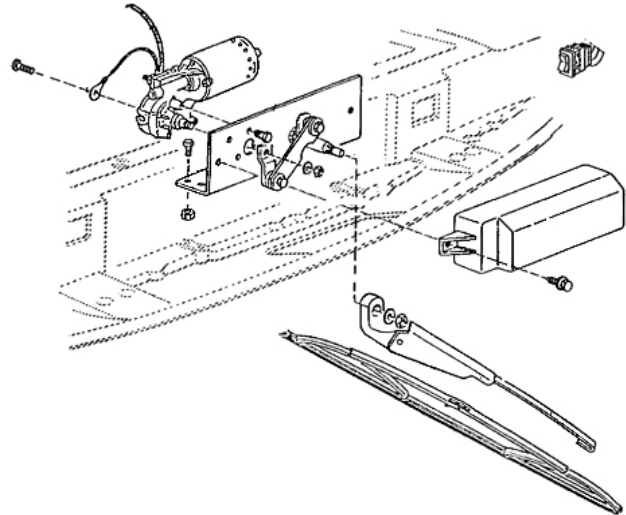

The attachment kit includes rear wiper motor, wiper arm, wiper blade, switch and installation hardware & instructions.

Order From	Bundle	Description
EPDC	AR112621	Single Speed Rear Windshield Wiper

### WINDSCREEN WASHER (FRONT & REAR)

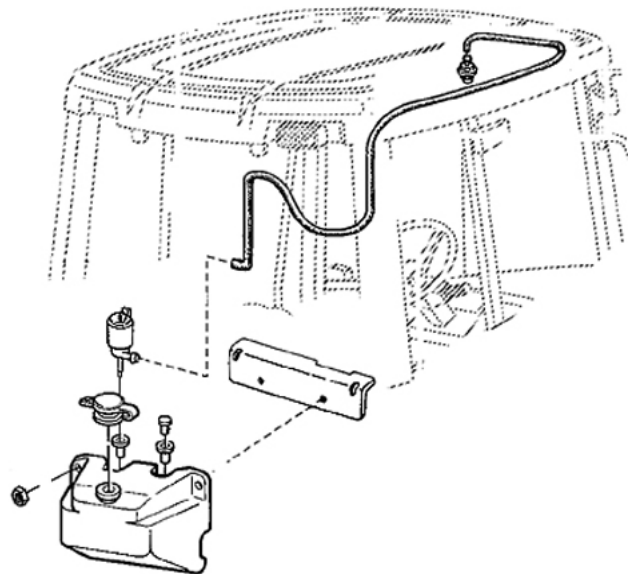

The attachment kit includes window screen washers front and rear, washer reservoirs, connecting hoses and installation hardware.

Order From	Bundle	Description
EPDC	AR112601	Front/Rear Washer Unit Kit

*Note: Western European tractors have a front washer in base equipment.*

## OPERATOR STATION ELECTRICAL

### POWERSTRIP ADAPTERS



Powerstrip adapters allow electrical connection for monitors and equipment not fitting the tractor’s standard Powerstrip or 3-pin outlets. Available adapters include:

- 1m cable for custom hard-wiring to components
- Cigarette lighter-style outlet
- North American-style flat 3-pin adapter (replicates 3-pin outlet found on Command Console)
- European-style round 3-pin adapter (as available on 6020-Series and pictured above).

Powerstrip adapters can also be used with the Field Office.

Order From	Bundle	Description
EPDC	RE67013	Standard Connector with 1m Cable (for hard-wiring electrical components)
EPDC	RE67014	Cigarette Lighter Outlet Adapter
EPDC	RE67015	NA 3 Pin Adapter for Powerstrip
EPDC	RE67016	RII 3 Pin Adapter for Powerstrip

### ANTENNA MOUNT AND WIRING FOR BUSINESS BAND (TWO-WAY) RADIO

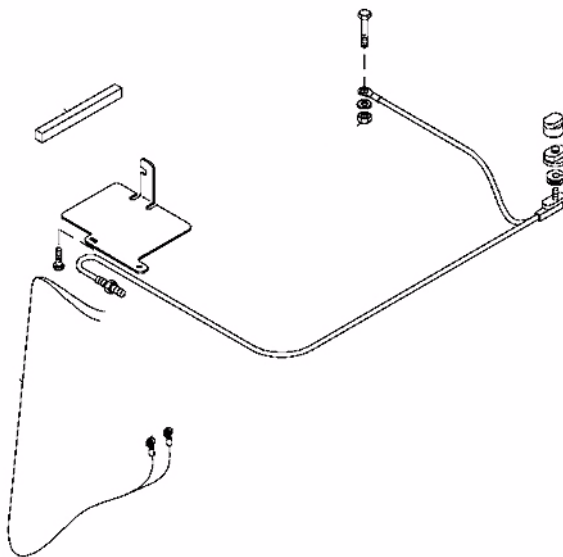

Provides the wiring and an external antenna mount for business band (two-way) radios.

Order From	Bundle	Description
EPDC	RE219922	Antenna Mount and Wiring for Business Band (Two-way) Radio.

### RADIO MAST ANTENNA KIT

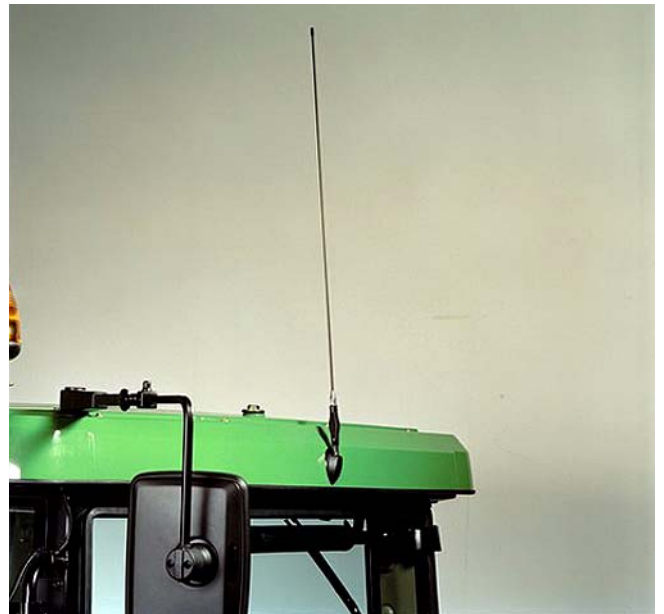

External radio mast antenna kit can be supplied to improve the radio reception on tractors equipped with an internal roof antenna. The external antenna is mounted with a three-position rosette and allows 90° forward / rear rotation to avoid damage from contact.

Order From	Bundle	Description
CG	RE233634	Radio Mast Antenna Kit

### REAR SPEAKERS

A kit containing two speakers is available to further enhance the sound quality of tractors where just two front speakers were factory-installed.

Order From	Bundle	Description
CG	AR114564	Kit, Two Rear Speakers

### CIGARETTE LIGHTER AND ASH TRAY

Cigarette Lighter heat element and Ash Tray can be supplied for those customers wishing to equip their tractor.

Order From	Bundle	Description
EPDC	AH104259	Ash Tray
EPDC	R212866	Ash Tray Insert
EPDC	AR60937	Lighter
EPDC	AH108380	Bulb

## LIGHTING

### FIELD VISION XENON HID REAR LIGHTING

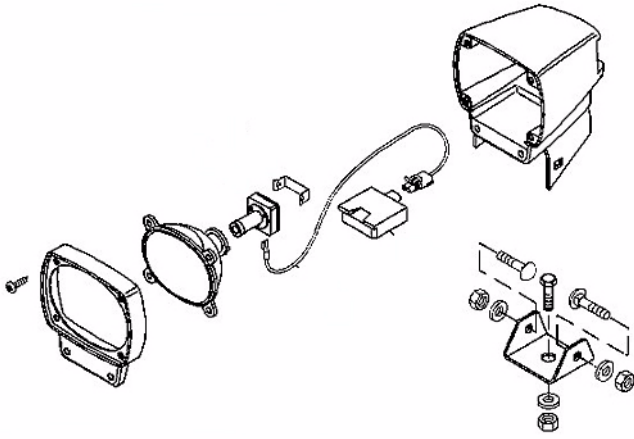

The fender-mounted Field Vision Rear Lighting bundle provides a Xenon High Intensity Discharge (HID) light for improved visibility to rear hitched implements when working at night or in low light conditions. Xenon HID lights provide extreme brightness and a daylight colour output for excellent field definition.

- 2.5x greater light flux (illuminance) than halogen working lights
- 35% lower energy consumption than halogen bulbs
- 5x greater service life than halogen bulbs.

One HID light is included per field kit. The factory-installed Rear HID lighting option installs two lights, one for each fender.

Order From	Bundle	Description
EPDC	RE203813	Field Vision Xenon HID Rear Lighting, Fender Mounted. <i>Includes one light per kit.</i>

### ROTARY BEACON LIGHT



Rotary beacon lights are available to meet requirements in commercial or governmental applications. The rotating, high-intensity light mounts on the front left corner of the cab roof in the up position when in use and can be lowered when not required to prevent damage. On / Off switch for the beacon light is located within easy reach of the operator.

Order From	Bundle	Description
EPDC	RE239930	Beacon Light Kit
EPDC	RE235448	Beacon Light Switch Kit

## PERFORMANCE MANAGEMENT

### RADAR SENSOR



Radar Sensor connects to both instrumentation options and Performance Monitor (if installed). This attachment kit includes Radar Sensor, wiring harness and installation hardware & instructions.

Order From	Bundle	Description
EPDC	RE237262	Radar Sensor Kit (Excl. UK)
CG	RE237261	3Radar Sensor Kit (UK only)

## PERFORMANCE MONITOR



The Performance Monitor displays information related to various speeds, area, distance and alarm data. A radar sensor is required for a 100% accurate calculation of wheel slip, distance covered and speed.

Attachment kit includes Performance Monitor, wiring harness, mounting bracket and installation hardware & instructions.

Order From	Bundle	Description
EPDC	AR114555	Performance Monitor <i>Requires Radar Sensor to achieve accurate readouts</i>

## IMPLEMENT ELECTRICAL FEEDBACK CONNECTOR

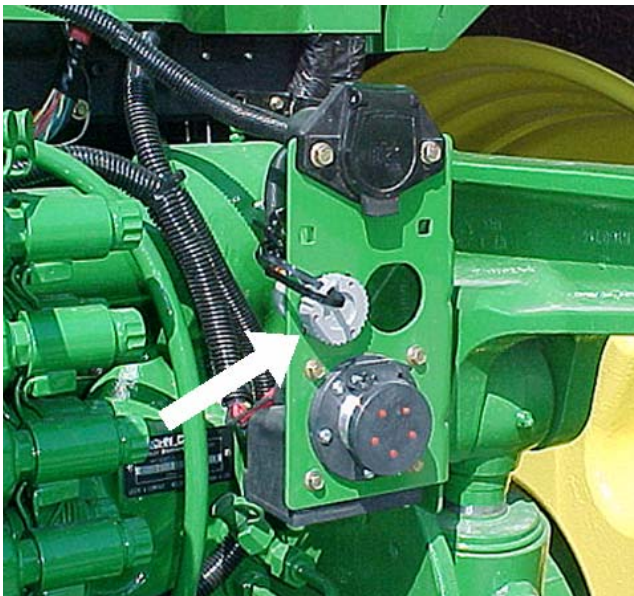

The 9-pin implement feedback connector required for TouchSet depth control of implements is available as a field-installed attachment. The connector and wiring harness enables a position input to be provided to the tractor's Selective Control Valve (SCV) control unit, enabling TouchSet depth control functionality. The feature allows the operator to adjust height and depth of remote lift cylinders by using the TouchSet controls in the cab.

The attachment kit includes a 9-pin connector, wiring harness and installation hardware & instructions.

Order From	Bundle	Description
EPDC	RE58827	Implement Electrical Feedback Connector Kit

*Note: Required for Touch-Set Depth Control. Requires implement components separately.*

## IMPLEMENT SWITCH

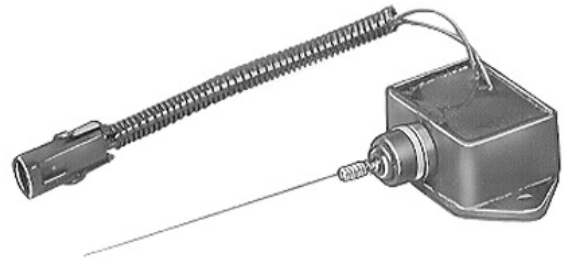

Mounts on the implement and monitors when the implement is raised or lowered. When used in conjunction with the Radar Sensor and Performance Monitor gives 100% accurate hectare coverage.

The attachment kit includes Implement Switch, 3m wiring harness and installation hardware & instructions.

Order From	Bundle	Description
EPDC	RE21519	Implement Switch Kit

## AG MANAGEMENT SOLUTIONS

### GREENSTAR READY

All GreenStar applications including AutoTrac, Parallel Tracking and Field Doc utilise the three GreenStar common components consisting of the GreenStar Display, the mobile processor and the StarFire receiver. Additionally, in order to form any fully-functioning GreenStar system on any of the 8000 Series wheeled tractors, "GreenStar Ready" status is first required. The GreenStar Ready status installs the necessary wiring harnesses required to run any of the three main GreenStar applications.

For tractors not already equipped GreenStar Ready, the following bundle must be installed:

Order From	Bundle	Description
AMS using JDMInt	* See AMS Price Pages	GreenStar System Harness for 80x0 Series tractors <i>Includes Cab Preparation brackets for the StarFire Receiver and the Display</i>



For applications utilising GreenStar Monitoring Implements, the Implement CAN Bus Wiring Harness which includes the ISO Implement connector is required.

Order From	Bundle	Description
AMS using JDmint	* See AMS Price Pages	Implement CAN Bus Wiring Harness

*Note: For further details of the specific GreenStar components required for AutoTrac, Parallel Tracking or Field Doc, please refer also to the AMS Ag Sales Manual.*

## PARALLEL TRACKING

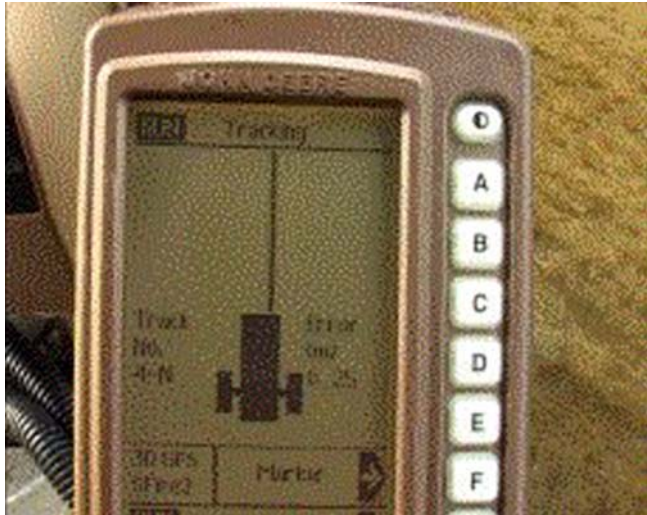

GreenStar Parallel Tracking provides a unique, modular solution for straight and curved-line tractor guidance, eliminating overlap and skipping. The operator can easily keep track of straight-line progress by occasionally glancing at the GreenStar Display or by listening to audible tones. GreenStar Parallel Tracking system thereby allows for:

- Reduced overlap and skipping
- Successful night-time operation
- Operation through adverse weather conditions

Parallel Tracking kits are available from AMS Europe using JDmint. Dealers are free to source the remaining GreenStar Common Components and a subscription to the StarFire SF2 differential correction signal required to form a functional system through using existing customer-owned items or by sourcing from AMS Europe and StellarSupport respectively.

For further code details, please refer to the AMS Sales Manual and Price Pages.

## AUTOTRAC ASSISTED STEERING



The AutoTrac Assisted Steering System greatly enhances tractor utility by providing fully automated vehicle guidance along successive parallel passes.

AutoTrac field kits containing all necessary hardware, brackets and the geofenced, platform-specific AutoTrac KeyCard in a single bundle are available from AMS Europe using JDmint. Dealers are then free to source the remaining GreenStar Common Components (inclusive Terrain Compensation Module) and a subscription to the StarFire SF2 differential correction signal required to form a fully functional AutoTrac system by using existing customer-owned items or by sourcing from AMS Europe and Stellar Support respectively.

For further code details, please refer to the AMS Sales Manual and Price Pages.

## FIELD DOC

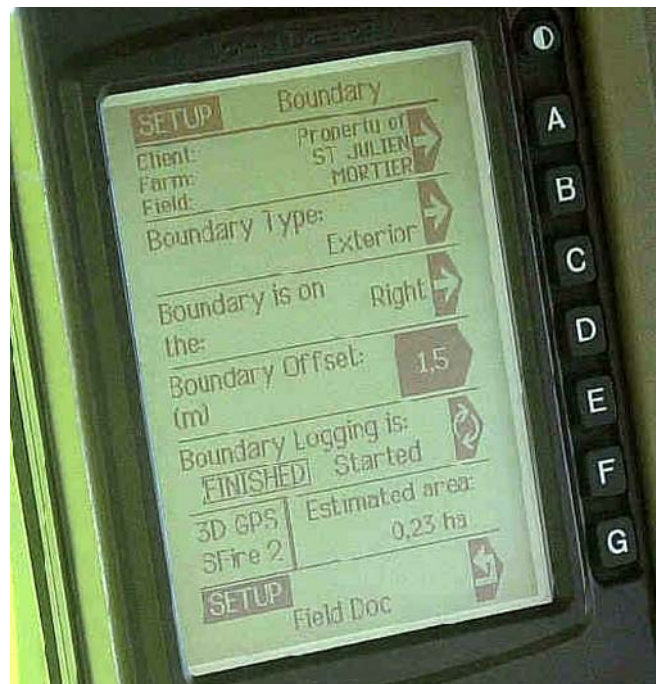

GreenStar Field Doc offers a simple way to record information on operations including tillage, seeding, spraying, fertilising and in applying manual or automatically variable input rates required for modern farm documentation practices. In addition, customers can also draw upon a simple and highly accurate boundary measurement tool incorporated into the Field Doc system.

Collected data is readily transferable to a home PC running JDOffice or other approved desktop software to provide valuable farm management information. Field Doc assists customers by:

- Optimising production.
- Reducing administrative paperwork for effective farm management.

For further code details, please refer to the AMS Sales Manual and Price Pages.

## JDLINK



The innovative GreenStar JDLink system from AMS allows customers to optimise the true performance capabilities of their 8020 by collecting machine data for management purposes. Using mobile phone technology, JDLink continuously transmits signals from the tractor's CAN Bus system to a central John Deere server where the information can then be made available to users via a JDLink website or through email, fax or SMS messaging.

JDLink field kits containing the Communications Controller and Cab Hardware are available from AMS Europe using JDmint. For further information on the JDLink system and the appropriate tractor bundles required to form a fully functional JDLink system, please refer to the AMS Ag Sales Manual and Price Pages.

## ENGINE

### COLD WEATHER START KIT



The introduction of a pilot injection system on the 8020 Series tractors reduces the need for use of the ether starting aid. Should customers frequently start tractors at or below -6 degrees Celsius however, a Cold Weather Start kit is recommended and available for field installation.

Order From	Bundle	Description
EPDC	RE242024	Cold Weather Start Kit

*Note: Tractor is pre-wired. Field installed cold weather start kit includes switch and ether aid canister.*

### OIL, AIR AND FUEL FILTERS

A set of replacement oil, air and fuel filters can be ordered for customers where access to a dealer is prohibitive. The kit contains:

- (1) RE164839 Air Cleaner Primary Element
- (1) RE172447 Air Filter, Secondary Element
- (1) RE174130 Oil Filter
- (1) RE187966 Recirculation Filter
- (1) RE24619 Air Assembly Filter
- (2) RE509672 Engine Oil W/Packing Filter
- (1) RE522687 Fuel Filter
- (1) RE522688 Fuel Filter

Order From	Bundle	Description
CG	AR195375	Oil, Fuel and Air Filters

## TRANSMISSION

### BACK-UP ALARM

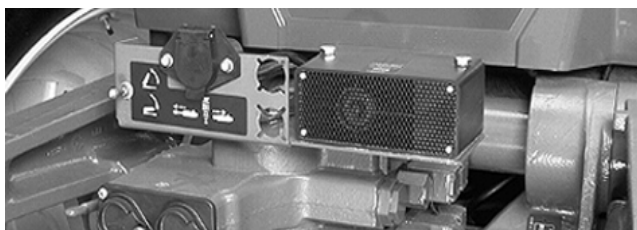

A Back-up Alarm is available to accommodate governmental or industrial sales of the 8020-Series tractors. The alarm sounds whenever the transmission is placed in reverse

The attachment kit includes a Reversing Alarm, wiring harness and installation hardware & instructions.

Order From	Bundle	Description
CG	RE61779	Backup Alarm

## WHEELS AND BALLAST

### FRONT WEIGHT SET - REGULAR



This attachment kit includes 20 Quick Tatch weights, each weighing 50 kg. There are 10 left front side weights and 10 right front side weights totalling 1000 kg.

Order From	Bundle	Description
EPDC	AL71258	Weight Set, 1000 kg <i>Requires Mounting Hardware - see following.</i>

### FRONT WEIGHT MOUNTING KITS

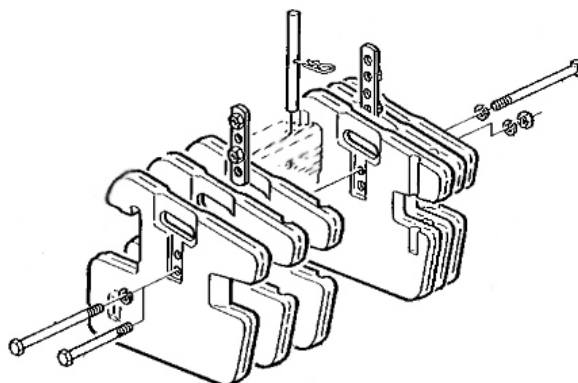

Attachment hardware for installing front weights can be ordered as follows. Two retainers, two washers and two cap screws (as appropriate) are required.

Order From	Bundle	Description
EPDC	AR68801	Retainer <i>Order 2 x AR68801</i>
EPDC	24M7241	Washer <i>Order 2 x 24M7241</i>
EPDC	19H1926	Capscrew for mounting 4 suitcase weights <i>Order 2 x 19H1926</i>
EPDC	R59761	Capscrew for mounting 12, 16 or 20 suitcase weights <i>Order 2 x R59761</i>

### TRAILER COUPLING FRONT WEIGHT SET

The attachment kit includes 2 special coupling weights weighing 50 kg each that can be used within a front weight package to create a trailer coupling. The total kit weighs 100 kg.

Order From	Bundle	Description
EPDC	AL119964	Weight Set, 100 kg

### REAR WHEEL WEIGHTS



Rear wheel weights are available for optimum ballasting and can be mounted on either of the inner or outer sides of the rear wheels as desired. Weight carrying capacities of the tyres must always be observed.

When mounting cast weights on the outside of the wheel, a 75 kg weight should first be mounted. Up to three, 205 kg weights can then be added per side. The first 75 kg weight is required to allow clearance to the gear for the rack and pinion when changing tread settings. Mounting the 205 kg weights directly to the rear wheel otherwise requires removing the weights when adjusting tread width.

Order From	Bundle	Description
CG	R167153	Rear Wheel Weight, 75 kg (Qty 2)
CG	R207782	Rear Wheel Weight, 205 kg
CG	R167151	Rear Wheel Weight, 645 kg

*Note: Mounting hardware required. See parts catalogue.*

## RIMS FOR HEAVY DUTY CAST WHEEL



Customers utilising the *Substitutable Rear Shipping Wheels* option can source rims to mount on the Heavy Duty Cast hub and centres supplied with the tractor.

- Allows for custom fitment of rear tyres
- Tight fit hole and slot hole on both the disk-to-rim and disk-to-axle centres the disc to rim.
- Well suited for heavier draft applications.

The following rims are available for all models in observance of restrictions offered ex-factory (5-step front: rear, etc). Unless stated, rims have 76.2 mm offset.

Order From	Bundle	Description
EPDC	RE172185	Wheel Rim for fitment of 320/90R50 tyres <i>Model 81- 8320 only. Group 46 tyre: note front tyre requirements</i>
EPDC	RE175532	Wheel Rim for fitment of 420/80R46 tyres <i>Model 81- 8320 only. Group 46 tyre: note front tyre requirements</i>
EPDC	RE175481	Wheel Rim for fitment of 480/80R42 or 18.4R42 tyres <i>Model 81- 8320 only. Group 46 tyre: note front tyre requirements</i>
EPDC	RE174760	Wheel Rim for fitment of 520/85R38 or 20.8R38 tyres <i>Model 81- 8320 only. Group 46 tyre: note front tyre requirements</i>

Order From	Bundle	Description
EPDC	RE161991	Wheel Rim for fitment of 320/90R54 tyres
EPDC	RE172186	Wheel Rim for fitment of 380/90R50 tyres
EPDC	RE172896	Wheel Rim for fitment of 380/90R50 tyres <i>174.8 mm offset</i>
EPDC	RE175533	Wheel Rim for fitment of 480/80R46, 18.4R46 or 520/85R46 tyres
EPDC	RE175484	Wheel Rim for fitment of 520/85R42 or 20.8R42 tyres
EPDC	RE176459	Wheel Rim for fitment of 520/85R42, 20.8R42 or 580/70R42 tyres <i>Model 81- 8320 only.</i>
EPDC	RE176460	Wheel Rim for fitment of 620/70R42 or 650/65R42 tyres
EPDC	RE166180	Wheel Rim for fitment of 650/75R38, 710/70R38 or 650/85R38 tyres
EPDC	RE175489	Wheel Rim for fitment of 900/50R42 tyres <i>0 mm offset</i>
EPDC	RE164038	Wheel Rim for fitment of 480/80R50 tyres
EPDC	RE174387	Wheel Rim for fitment of 620/70R46 tyres
EPDC	RE224262	Wheel Rim for fitment of 710/70R42 tyres
EPDC	RE171073	Wheel Rim for fitment of 800/70R38 tyres <i>0 mm offset</i>

*Note: Tyre load carrying capacities must be observed.*

## FRONT WHEEL TREAD SPACERS



Available are 25.4 mm tread spacers for multi-position front wheels.

Order From	Bundle	Description
EPDC	R115278	Bolts (24 required)
EPDC	R115277	Tread Spacers (24 required)

### CHOCK BLOCKS



Chock blocks are advised for use as an additional safety measure when parking tractor / trailer combinations and to fulfil statutory regulations where required. Additional Block Holder bracket can be assembled when not previously supplied ex-factory (see Parts Catalogue).

Order From	Bundle	Description
EPDC	AL26777	Chock Block (Quantity 1)

## HYDRAULICS

### FOURTH SCV



The attachment kit includes a fourth SCV, SCV control assembly, potentiometer, wiring harness, couple with release lever, dust cover and installation hardware & instructions.

For details of equipping four rear SCV's on Independent Link Suspension tractors that are equipped with the ex-factory front hitch, please refer to the bundle kit *Fifth SCV*.

Order From	Bundle	Description
EPDC	RE188662	Fourth Remote Cylinder Control Valves with Breakaway Couplers

### FIFTH SCV

The attachment kit includes a fifth SCV, SCV control potentiometer, couple with release lever, dust cover and installation hardware & instructions. The SCV control lever mounts onto the side of the CommandArm, adjacent to the fourth SCV / front hitch control lever.

The fifth SCV coupler kit can also be installed to serve as the fourth coupler on tractors that are already equipped with the ex-factory front hitch. This fourth electrohydraulic selective control lever will be located in the same 5th SCV position on the CommandARM.

Order From	Bundle	Description
EPDC	RE188663	Fifth Remote Cylinder Control Valves with Breakaway Couplers <i>Can also be used as SCV #4 on Independent Link Suspension tractors equipped with the factory-installed front hitch. Five rear SCV's are not possible in this case.</i>

### POWER BEYOND SYSTEM

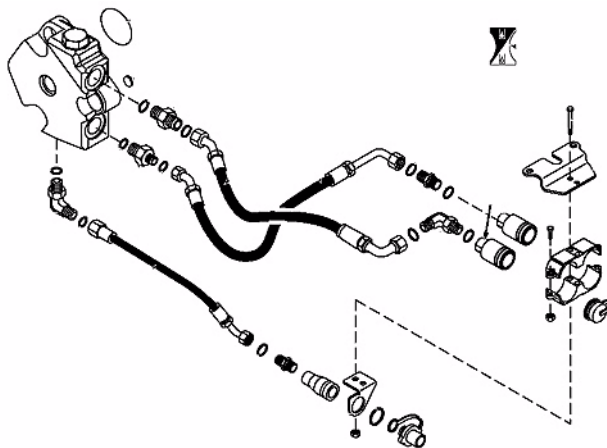

Many implements including manure spreaders, forage wagons, seeders and sprayers requiring hydraulic power are equipped with their own pressure and flow compensating hydraulic valves to independently control oil flow. For these applications, the Power Beyond System can be equipped to provide live hydraulic power independent of the tractor's own SCV performance, ensuring adequate, controlled power supply to the implement and optimising tractor performance when the supply is no longer needed.

The attachment kits include couplers, connecting hoses, dust covers and installation hardware & instructions. An additional adapter kit is required for tractors where the hydraulic trailer brakes are installed.

Order From	Bundle	Description
EPDC	RE217697	Power Beyond Coupler Kit <i>Adapter kit required for tractors equipped with hydraulic trailer brakes.</i>
EPDC	RE234298	Adapter kit <i>Allows simultaneous use of Power Beyond and hydraulic trailer brakes.</i>

### HYDRAULIC MOTOR RETURN

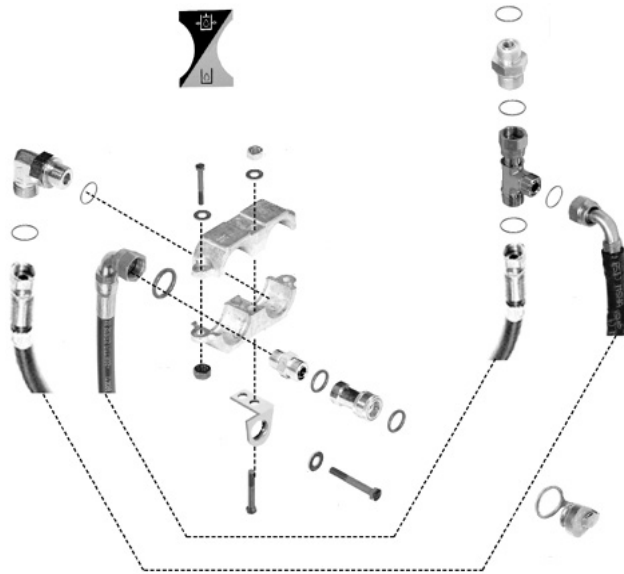

Hydraulic motor return kits allow the return of used hydraulic oil directly into the tractor’s sump, bypassing the remote coupler and SCV. The kits are then ideal for use with implements where minimal back pressure is desired, i.e. those equipped with hydraulic motors or where hitch valves with lift assist wheels are installed.

The Hydraulic Motor Return / Auxiliary Hitch Coupler / Sump Return Kit has one return outlet while the Multiple Return which has two. Both attachment kits also include dust covers, installation hardware & instructions.

Order From	Bundle	Description
EPDC	AR114664	Hydraulic Motor Return / Auxiliary Hitch Coupler / Sump Return Kit <i>For use with Hydraulic Motor Returns or on Hitch Valve with Lift Assist Wheels.</i>
EPDC	RE67182	Multiple Motor Return Kit

### LOW STANDBY PRESSURE CONTROL KIT

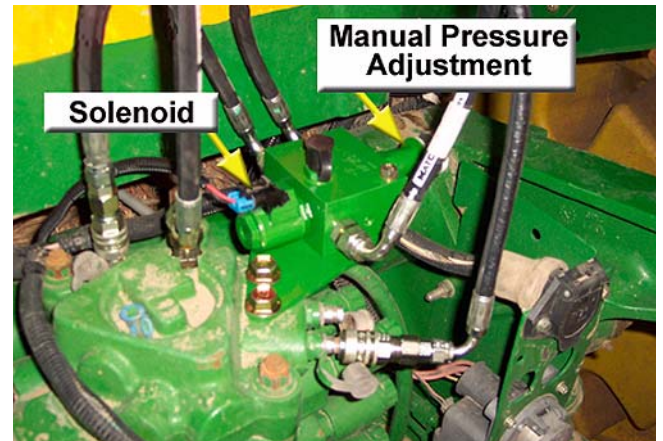

Low Standby Pressure Control Kit eases installation and operation of equipment using Power Beyond. Customers will be able to manually adjust the standby pressure of the tractor to the application and electronically turn the load sense signal on or off from the cab. The load sense signal should always be turned off when starting the tractor. Turning the load sense signal off will keep the pump at low standby pressure while cranking the tractor.

As a further benefit, when the Power Beyond application is not needed, the valve could also be turned off, reducing power needed to operate the hydraulic pump and lowering fuel consumption.

Order From	Bundle	Description
CG	RE221284	Low Standby Pressure Control Kit

### WAGON TRAILER TILT KIT

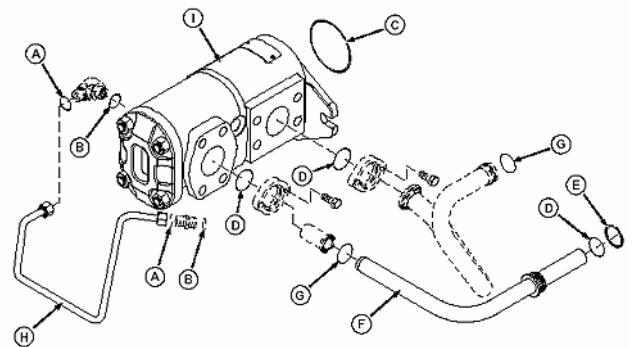

Available Wagon / Trailer Tilt Kit enables adequate hydraulic flow when rapidly filling the large, single acting hydraulic cylinders required of many tipping trailers. A higher capacity charge pump maintains oil supply to the primary pump with oil from the differential case, ordinarily unachievable when the tractor is stationary and preferably run at lower engine speeds.

- Max hydraulic oil takeout capacity with kit is raised by 18 l over standard specification to 38 l.

Order From	Bundle	Description
EPDC	RE221808	Wagon / Trailer Tilt Kit <i>For use with large, single acting cylinders. 8020-Series only</i>

## HYDRAULIC TRAILER BRAKES

Hydraulic trailer brakes allow modulated braking of trailers equipped with hydraulic brake systems for safer and more controlled braking. The system utilises a delay valves that actuates the trailer brakes immediately prior to tractor braking:

- Connects directly to tractors hydraulic system.
- Does not require a separate oil reservoir.

The attachment kit includes hydraulic trailer brake valve, coupler and installation hardware & instructions. An additional adapter kit is required for tractors where the Power Beyond system is to be used.

Order From	Bundle	Description
EPDC	RE232959	Hydraulic Trailer Brake System Fits all 8000, 8010 and 8020 Series Wheel Tractors
EPDC	RE234298	Adapter kit <i>Allows simultaneous use of Power Beyond and hydraulic trailer brakes.</i>

## HOSE IDENTIFICATION KIT

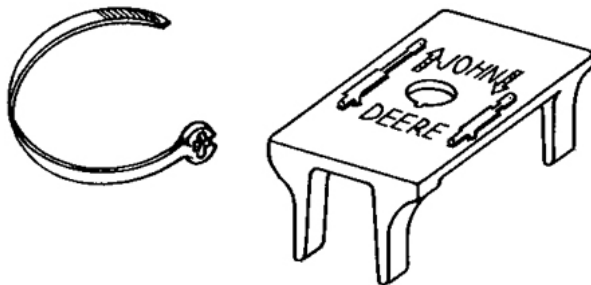

The kit contains plugs, tag, band and instructions.

Order From	Bundle	Description
EPDC	AR103808	Hydraulic Hose Identification Kit

## HITCH EQUIPMENT

### LAFORGE GREENLINK FRONT HITCHES



Approved front hitches are available for both Independent Link Suspension and regular 4WD front axle tractors in two configurations: **Standard** and **Heavy Duty**.

Standard hitches are designed for carrier applications and light finishing equipment. Heavy-Duty hitches are designed for extreme stress applications - for pushing high draft tillage implements that are subject to severe shock loads. Heavy-duty applications include front-mounted ploughs, chisel ploughs, rippers and three-point blade. Heavy-Duty hitches are also well suited for using optional automatic controls.

#### Available hitch models

##### Regular 4WD front axle tractors:

- GreenLink St 4/8 standard hitch
- GreenLink 80.2 C Heavy-Duty hitch
- GreenLink 80.2 I Heavy-Duty hitch

##### For Independent Link Susp. tractors:

- GreenLink St 5 standard hitch
- GreenLink 80 CS Heavy-Duty hitch
- GreenLink 80 IS Heavy-Duty hitch

The standard hitch for regular 4WD front axle tractors has a **4000kg** lift capacity over **750mm**, while all heavy duty hitches have a **5600kg** lift capacity over **800mm** travel, subject to maximum tyre and axle load ratings. All hitches maintain full steering capabilities and those for Independent Link Suspension tractors are also compatible for front dual use.

Field installed models by LAFORGE operate using a tractor's SCV. Connecting the hitch to rear SCV number one allows usage of automatic position or position and traction control controls. These can be included in the function of an IMS sequence.

LAFORGE has a patented InterCoupler quick-attach system, available exclusively on 8000 through to 8020 Series tractors. This allows for full ground contour following by the implement while maintaining weight on the tractor and constant working depth. This also avoids torsional stress, reduces fatigue, improves traction and steering, plus accommodates the optional weight transfer system for optimal traction and steering capability.

Field installed front hitches are distributed and warranted by Laforge SARL, who are solely responsible for the performance, quality, safety, specifications, prices, discounts, terms, and service.

Laforge SARL

Ph: +33 (0) 323 798 585

Fax: +33 (0) 323 798 175

Email: hd.laforge@wanadoo.fr

### REMOTE HITCH RELEASE CABLES

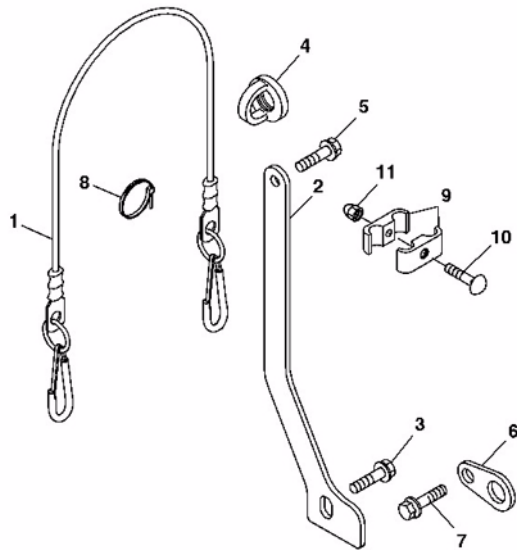

Remote Hitch Release Cables for the Walterscheid Hook Hitch assist implement hook-up and detachment from within the operator station.

Order From	Bundle	Description
EPDC	RE187291	Remote Hitch Release Cables- For Walterscheid Hook Hitch

## STORAGE

### STORAGE CONTAINER - 45L



(6020 shown)

The 45 l Tool Storage Container can be mounted to either of the tractor's base weight, its Quick Tatch weights (requires Trailer Coupling Set) or the 900 kg Pick up Weight for convenient storage of tools and implement equipment.



The volumous sheet metal storage container can carry up to 45kg of gear and includes side handles for easy movement between machines. A quick lock pin secures the container lid.

Order From	Bundle	Description
EPDC	AL120005	Storage container, 45 l Max. 45kg payload



---

## VANDALISM PROTECTION

---

### DOOR LOCK KIT



Door lock kit provides individually keyed cabin door locks as a deterrent to vandalism and theft. The kit also aids in satisfying insurance policies where commonly keyed vehicles cannot be guaranteed cover against damage or theft.

Kit contains two handles with lock cylinders, four keys and installation instructions and is retrofittable to 8000 and 8010-series tractors. Further spare keys can be cut from the blank.

Order From	Bundle	Description
EPDC	AL71345	Door Lock Kit
EPDC	AL71350	Blank Key